



*Hägdalens Centrum, Stockholm. Project: Ungdomsbostäder, Kv. Tvärslån. Architect: Schweiwiler Svensson Arkitektkontor AB.
Product: steni colour T7 HM. Colours: NCS S 1050-Y10R, NCS S 1050-Y30R, NCS S 2060-Y80R, NCS S 3030-R40B,
NCS S 4030-B10G og NCS S 2040-G30Y. Photo: Denniz Corsman*

steni[®] colour

steni colour quality panel
- highly flexible on dimention, shape and colour

11894/2009



Building knowledge

steni[®] colour



Lanternan, Västra Hamnen, Malmö, Sweden. Product: **steni colour** T7 - NCS S 5040-R80B and NCS S 0500-N, matt. Photo: Denniz Corsmann.



The facade of the future is very functional and esthetical

The architectural expression of the facade is first of all about creating a functional and esthetical facade that will harmonize with other buildings nearby. It is also about economy. **steni colour** has a documented durability period of 60 years, and offers one of the best guarantees on the market. **steni colour** is made of glass fibre reinforced polymer composite, and can withstand any climate condition.





Composite – the construction material of the future

A polymer, reinforced with glass fibre is more and more frequently used in car, boat and aircraft production, as well as for products that are exposed to extreme stress. Polymer composite is the basis of **steni's** facade products - the main reason for **steni's** longlasting durability and the best guarantees on the market.

3 gloss levels. Unlimited combinations!

The complete **steni colour** program consists of 3 gloss levels:

- High gloss (gloss ca. 70) – 15 standard colours
- Half matt (gloss ca. 20) – 40 standard colours
- Matt (gloss ca. 3) – 40 standard colours

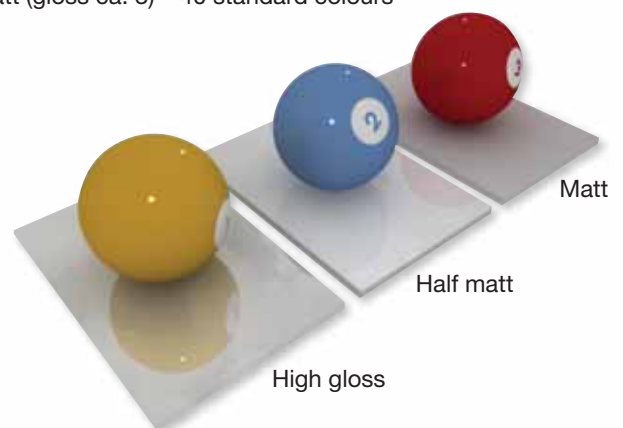



Design and quality in the same facade panel

steni colour is a facade panel made of glass fibre reinforced polymer composite, with a smooth surface of electron beam cured acrylic. (100% acrylic without the use of solvents) **steni colour** has the same documented quality as the other **steni** products, impact-, water- and weather resistance. The facade panel is suitable for both new buildings and renovation of buildings. **steni colour** is an exciting alternative where design is an important factor, because of its colour possibilities, surface variations and format flexibility.

*Måseskär, Göteborg, Sweden. Architect: Sweco FFNS Arkitekter.
Product: steni colour T7, half matt. Photo: Denniz Corsmann.*



The esthetical, flexible and functional facade

steni colour allows many architectural expressions through its colour flexibility and alternative gloss levels. The facade panel is very well suited in combination with other facade materials like glass, steel, aluminium, wood, plaster etc.



steni facade panel has unique qualities and long durability



steni colour is 100% weather and water-resistant, and can be submerged in water without being damaged. steni colour has a 25-year working guarantee!



steni colour is extremely frost resistant. The panel retains 90% of its mechanical strength at temperatures from -50°C to $+80^{\circ}\text{C}$, and withstands more than 300 frost cycles without being damaged!



steni colour has a smooth surface of electron beam cured acrylic. This makes the panel very UV-resistant.



steni colour is highly chemical resistant, tolerating all chemical compounds and concentrations found in the air and in precipitation in industrial areas.



steni colour is very easy to clean. Graffiti can easily and quickly be removed without physical or visual impairment of the exterior.



steni colour is robust and impact-resistant, making it highly suitable for exposed places. The facade panel's breakage is virtually zero.



steni colour (types 6 and 7) are fire-classified (SITAC standard approval certificate no. 0478/98)



steni colour does not contain halogens and is considered to be an inert (chemically neutral) material. See our environmental description!



steni colour is a facade panel with many possibilities, and it is flexible through both form and format

steni colour is produced in a continuous process. This makes our panel's very format flexible with a minimal of waste. Most formats are special cut at the production plant. The panels can also be delivered already drilled.

steni colour is delivered on building site with a complete fixing instruction.

steni colour panel can be supplied as L- or U-elements, in different angles. It can also be fixed curved on the building. The look of the building can also be complimented with different fixing systems, profiles and screws.

steni colour can be figure cut by advanced water jet technology.

steni colour is suitable where special demands are required.





Customer service



Certified



Colour flexibility



Web solutions



Technical support



Formats

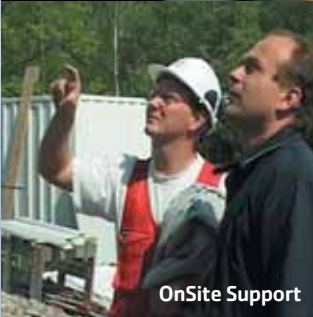

OnSite Support



www.steni.com



Logistics

- furthermore, steni gives you one of the best product guarantees on the market

In NBI Technical Approvals Norwegian Building Research Institute gives **steni** facade panels an expected functional durability period of 60 years. **steni** is certified according to NS-EN ISO 9001:1994 quality system.



steni[®] colour

The environments best friend

During the development of **steni** facade panels we are very conscious about being environmental friendly. Several independent tests confirm that **steni** facade panels are among the most environmental friendly products on the market.

Technical data

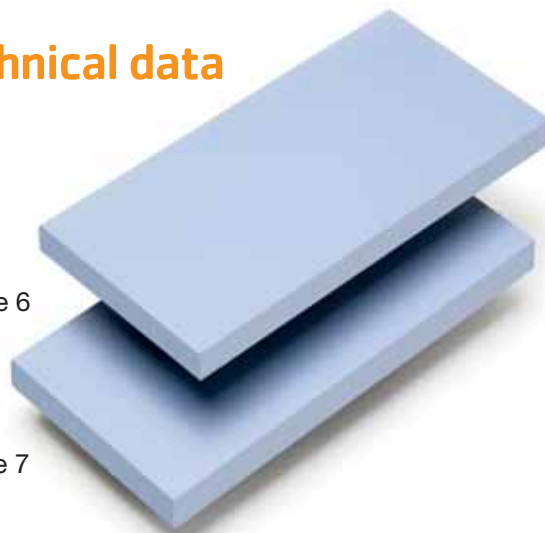

Type 6

Type 7

steni colour is supplied in two types of thickness, Type 6 and Type 7

Summary of technical data sheet:			
Characteristic:	Type 6:	Type 7:	Unit:
Thickness	5,5 ± 0,6	6,5 ± 0,6	mm
Weight	ca. 11	ca. 13	kg/m ²
Density	1880	1880	kg/m ³
Temperature of expansion	0,026	0,026	mm/m°C
Heat resistance	0,0074	0,0074	m ² /K/W
Heat conductivity	0,55	0,55	W/m ² K
Fire class: Depending on country			
		Unit	Standard
Water density	100		NS 3530
Water absorption 24 hours	< 0,2	%	ISO/R 62-1999
Water absorption 28 days	1,5%	%	ISO/R 62-1999
Humidity/dimension alterations	5,2 x 10 ⁻⁶	mm/%RF	NT BUILD 113
Penetration of water vapour	3,3 x 10 ⁻¹²	kg/m ² sPa	ASTM E96-66
Frost resistance,			
no damage	>300	cycle	NBI

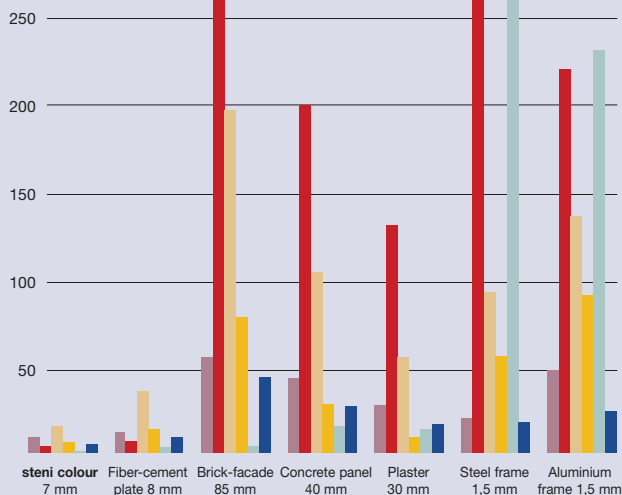

Ecological comparison of different facade materials.

- Energy Content** ((MJ) 10³/m² wall surface)
- Acidification Potential (AP)** ((g(SO₂)/m²)/wall surface)
- Photochem. Ozone Creation Pot.** (POCP) ((mg(C₂H₄)/m²)2,5)10⁻¹/wall surface)
- Global Warming Potential (GWP)** ((g(CO₂)/m²)10⁻³/wall surface)
- Nutrification Potential (NP)** ((g(phosphates)/m²)10⁻¹/wall surface)
- Critical Air Volume (CAV)** ((1000 m³ of substitutal air) 10⁻¹/wall surface)

Extract from Tampere University of Technology, Dept. of Civil Engineering, Institute of Construction Economics and Management; Ecological Comparison of Facade Renovation. The separate columns compare the actual ecological loading for each product group (low value reflects low environmental loading). The diagram does not rank the various environmental loads against each other, because of differing designations/weighting and environmental consequences.

We will be pleased to send you the complete report - available in Finnish and English.

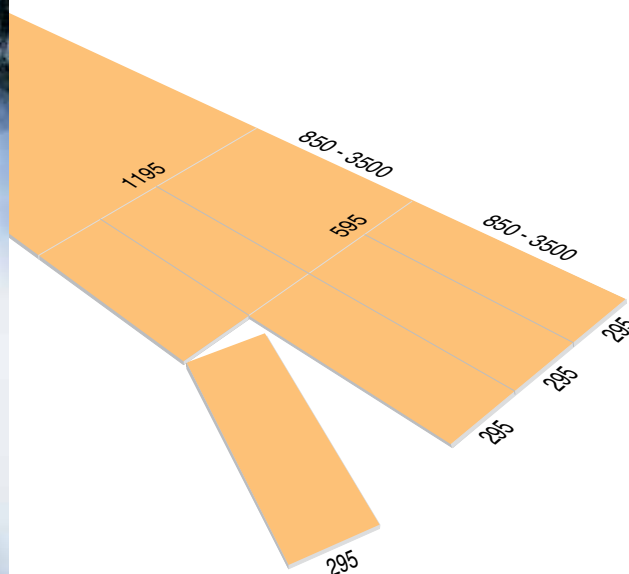

The best format flexibility on the market

steni colour are to be fixed as ventilated cladding

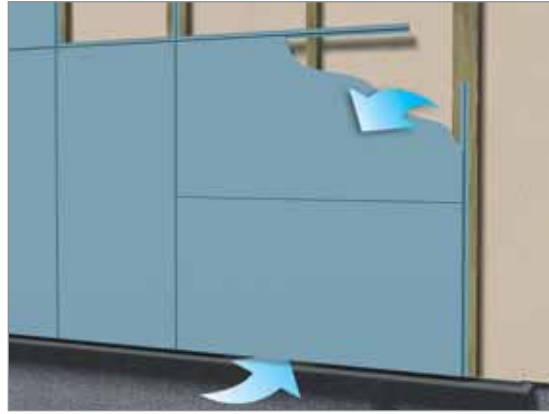

steni accessories

steni colour can be supplied as L- or U-elements in different angles.



steni colour
U-element



steni colour
Corner element



steni colour
Corner element



steni colour
L-element



steni colour
Wide u-element



Horizontal and vertical joint profile
FP-6-30



Horizontal profile
57467



Corner profile
4970



Corner profile
CP 12-18-33



Vertical profile
4941

steni fixing systems

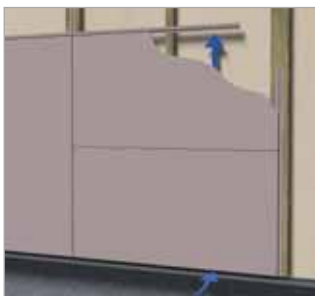

FS100

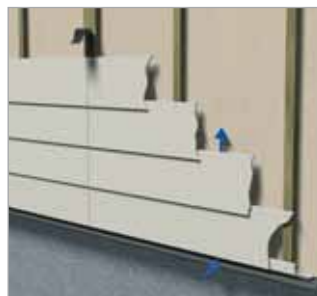

FS200

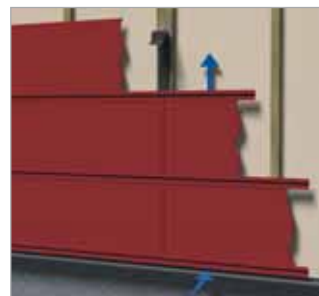

FS300

steni facade panels are to be fixed as ventilated cladding on impregnated wooden laths, steel- or aluminium profiles. For more information ask for our fixing instruction booklet, or look at the fixing instructions on our web page; www.steni.com

Organisation

steni as is an international company with about 120 employees. We have sales companies in Denmark, Finland, Norway, Sweden, United Kingdom and Netherland. Our production plants are located south of Oslo and in Wrexham, Wales, where we produce our products for both the national and international markets. In Europe, USA and Canada we have agreements with distributors for sale and marketing of our products.

History

The original **steni** facade panel was developed in Sandefjord, and introduced to the Norwegian market in 1965. The **steni** head office and main production premises are situated at Steinsholt in the municipality of Vestfold in southern Norway. Since we started more than 40 years ago steni products have grown rapidly, and now cover a wide range of products. Up until now we have delivered more than 25 million m² facade panels.

Products

Exterior panel

steni nature – with a surface of crushed natural stone

steni colour – with a surface of hardened acrylic

steni imago – with a surface of ceramic coloured stone

Interior panel

steni effect – with a surface of hardened acrylic for interior use

Balcony panel

steni duo – with a two sided surface of hardened acrylic

Foundation panel

steni terra – with a surface of crushed natural stone for use on foundations

System building

Stoneflex - Moduflex - Anti Slip - Agriflex

steni agri - with a surface of hardened acrylic.



www.steni.co.uk

steni uk ltd.

Units 1-4, Vauxhall Industrial Estate,
Ruabon, Wrexham LL14 6HA
Tlf.: + 44 (0) 1978 812 111
Fax: + 44 (0) 1978 810 399
E-mail: info@steni.co.uk

